



8

- 8: View to the back of the monument ,distrubution center' © Claudia Dreyße, 2011
- 9: View to the bastion of the first of three squares with the barrier free ramp. © Claudia Dreyße, 2011
- 10: Upside the bastion, first square view to the ,distrubution center' © Claudia Dreyße, 2011
- 11: view along the sail-shaped wall of the second square © Claudia Dreyße, 2011
- 12: Backside of the ,distrubution center' © Claudia Dreyße, 2011
- 13: side plan of the competition © Planergruppe Oberhausen, 2002
- 14: View across first square to the front of the ,distrubution center' © Claudia Dreyße, 2013
- 15: ,distrubution center' during demolition © Planergruppe Oberhausen
- 16: site plan © Planergruppe Oberhausen 2011
- 17: Detail view showing the wall of the second square © Claudia Dreyße, 2013



9



10



11



12



14



15

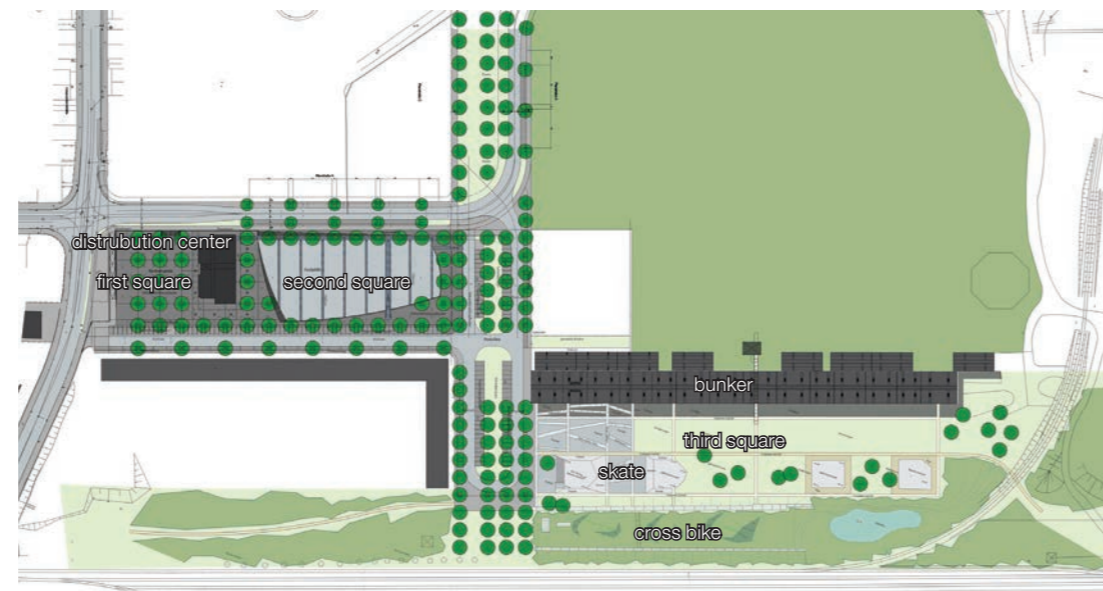

16

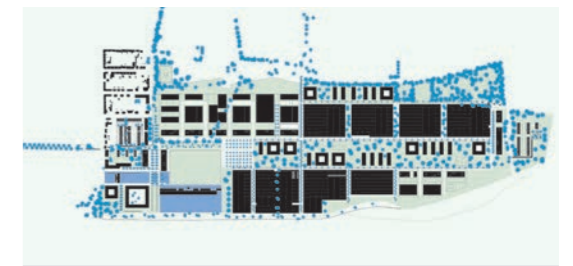

13

In the direction of the city center, the three squares of the Schalke Verein are first presented with a bastion of brickwork, which emphasizes and encloses the monument of the former distribution center. A ramp serves as a barrier-free access suitable for cyclists from the Hohenzollernstraße to the flat plaza with its pattern of trees. Stairways provide direct access from the Hohenzollernstraße. The plaza of basalt paving is structured by barrier-free walkways made of large-format slabs. The tree grid offers opportunities for use as a small marketplace for which electrical installations are provided. To the east of the distribution center starts the second square. Here, too, the basalt paving forms the framework for a slightly sloping, robust asphalt surface, which is structured by large-format concrete slabs. In the west, the difference in height is opened up by stairs. In the south, the wide, curved, sloping walls of the square trace the contour of a sail. The dimension of the free area of the fairground also offers larger events space. Three lighting pillars tipped in the slope of the concrete wall throw concentrated light onto the asphalt surface.



17